

TIDAL WAKE[®]

Love The Wake You Make!

XLR8

INSTRUCTIONS



Welcome to the Family!

Family, Friends, and FUN – that’s what boating is for us! Tidal Wake raises the tide in recreational boating accessories and water-wares with innovative gear that makes your boating experience great.

There is something about being on the water that brings people together. Enjoying a warm day, a misty spray, or a beautiful sunset, is better when experienced with friends and family.

Whether your catching a gnarly ride or rocking in the gentle afternoon waves, being towed or dipping your toes, the water seems to magically wash away the cares of the day and creates beautiful, lifetime memories.

From our families and friends to yours...Welcome!

How It Works

Tidal Wake Shaper attaches to the side of your boat hull. It disrupts the flow of water around that side of the boat. This allows the wake on the opposite side of the boat to grow and develop into a nice wake for surfing.

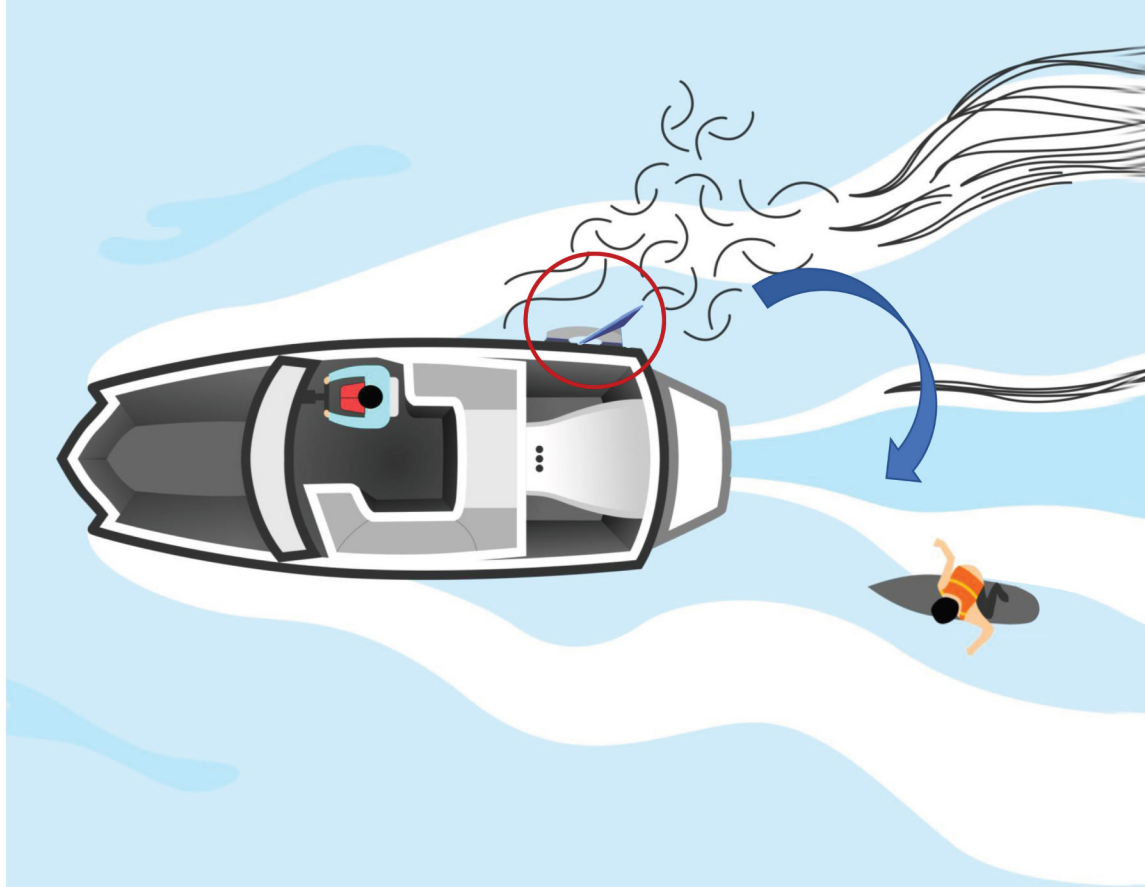

What's Included:

- Tidal Wake Shaper Body
- XLR8 Fin
- Low Re-Coil Lanyard
- Compact Zippered Tote bag
- Instructions
- Warranty card
- Tidal Wake Koozies (2)
- Great Fun!



Fin Color
Options

PREPARE/ASSEMBLE

1. Remove Tidal Wake Shaper body, fin and lanyard from its tote bag.
2. With the levers down, assemble the fin as illustrated in figure 1. By placing the opening of the fin onto the side center of the body at the narrowest point (a). Rotate the fin 90 degrees so it fits easily over both sides of the body shown as (b).
3. Place thumbs on both bottom sides of the fin (c), Push back until Fin's hook clears the top of the body, then pull both bottom sides slightly forward so hook drops into slot (d).
4. With the fin in place, lift the fin lever up, turn device over, and rotate the locking tab 90 degrees to open up the locking wedge channel (e). Slide the locking wedge into place (f). Rotate the locking tab 90 degrees back again so that it is completely blocking the bottom of the Wedge holding it in place (g).

Lanyard Use (Pictured below):

XLR8 floats, but we highly recommend using a lanyard. A) Feed lanyard string through the lanyard cup's loop, then feed the lanyard's metal hook through the string's loop. B) Prior to installing XLR8 onto the boat, with the lever up, position the lanyard so it is on the top and easy to attach to the boat's hardware when the XLR8 is installed on the boat.

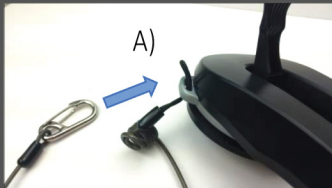

LEVERS UP



UNLOCKED (e)

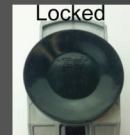

LOCKED (g)

Parts & Assembly



ATTACH to Your Boat Hull



1

CLEAN - Be sure the boat surface is clean, free of algae or other lake, river or sea surface residue.

2

LANYARD LOOP - With the suction levers up, rotate the lanyard loop to the top-side.

3

PLACE/PRESS - With the suction cup levers up and Tidal Wake in place, press firmly against the boat's hull to expel as much air as possible

4

ENGAGE SUCTION - Press both levers down to lock in place. You will feel resistance as they engage the suction. Be sure the levers are flat against the TIDAL WAKE body. Pull slightly up and down to assure your Tidal Wake is secure.

5

SECURE - TIDAL WAKE floats but we highly recommend using our low re-coil lanyard for added security.
Practice maneuvering the boat with Tidal Wake installed before driving around or retrieving a surfer.

ADJUSTING THE WAKE

Start with the XLR8 as far on the boat while still on a flat surface. Set the height so that the end of the fin is 1/2 below the water at 0 mph.

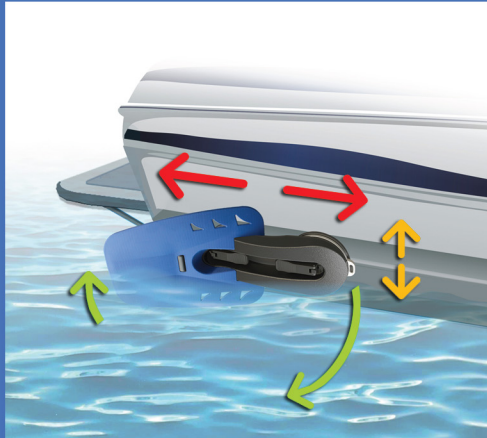

Depending on the boat brand model, some hulls have chines/elevations changes on the hulls surface that may limit or restrict position of the shaper on the boat.

There are several things you can do to create different wakes.

Moving TIDAL WAKE more Forward or Aft. ← →

Moving TIDAL WAKE Up or Down Setting the Depth. ↑ ↓

Changing TIDAL WAKE's Pitch by mounting one of the suction cups higher or lower on the hulls side ↙ ↘

Adjusting the ballast in the boat... adding or reducing weight. Listing to surf side or evenly weighted. 

Adjust your surfing speed. Each hull design is different. Start at 10-11mph, but don't exceed 13mph. 



STORAGE & CARE

- Remove Fin by releasing the suction cup and turning the locking tab
- Pull/slide out the Locking Wedge & remove fin
- Replace locking wedge and lock tab for storage
- Place Tidal Wake Body in main compartment of tote, lanyard end first
- Place fin in tote on top of the body with the hook facing up away from the body
- Zip shut and stow away until your next surf!
- Use front pocket to store instructions & Koozies



Wind

Ballast

Water

Depth

Listing

Speed

What else
affects my
wake?

Conditions

Wake Surfing Courtesy: Keep lawful distance from shore, docks, channels, buoys and other boaters, including SUP, kayak, canoes, jet skis, and swimmers.

TIDAL WAKE™

10700 Highway 55, #260
Minneapolis, MN 55441 USA
TidalWake.com

A division of McNaughton Inc.

Products to Make Your Boat More FUN!

Check out our full line at TidalWake.com

Fin Wallet & Other GEAR



LED Underwater Boat Drain Plug Lights



WARNING:

- The sport of wake surfing and the use of this product can involve inherent risk of property damage, injury or death. As with any sport, please participate with caution and understanding. Always wear a personal flotation device when wake surfing.
- TIDAL WAKE SHAPER must only be used on INBOARD, V-drive, or reverse drive boats by a legal boat operator. Wake surfing behind boats with an outboard motor, inboard/outboard drive system or any boat that has an exposed prop or propulsion system is extremely dangerous and may cause injury or death. Wake surf Safely.
- TIDAL WAKE SHAPER is a RECREATIONAL MARINE DEVICE
- USING TIDAL WAKE SHAPER IS VOLUNTARY. The user assumes all risk and liability for any property damage, injury or death.
- Improper use could result in bodily injury, death or property damage. Improper use could result in bodily injury, death or property damage.
- TIDAL WAKE SHAPER should only be used by an adult who has read and understands the user manual/instructions
- TIDAL WAKE SHAPER may affect the handling of your boat. **Practice maneuvering** with TIDAL WAKE SHAPER on your boat at various speeds within the recommendations prior to attempting to wake surf or pick up fallen riders. **Use caution when approaching fallen riders.**
- Remove your TIDAL WAKE SHAPER when you are done surfing. You will be driving at speeds over 13 mph and especially prior to docking or maneuvering around other boats. Damage to your boat or your Tidal Wake Shaper can result from contact with fixed objects or other boats or floating objects.
- Only to be used on INBOARD BOATS by a legal boat operator.
- **Never exceed 13 mph** while using this device, even when returning to pick up a surfer who has fallen.

Please Read this entire warning for your own safety and the safety of others.



Be Safe!
Have
FUN!